

4Stage System Accessories

Top Joiners, Leg Joiners & Steps for the 4Stage System

The 4Stage System is a family of products from rostra Tops, Legs, Handrails and Posts. Below are a few standard Accessories we currently offer to complete the system assembly, more variants are available on request and can be designed to your specific needs:

Description:

Part Number:

Plan View:

Isometric View:

Top Joiner Assembly.
Used for joining rostra assemblies together via their Top extrusions.
Comes with M10 fixing kit & a 17mm spanner is required
(self weight: 0.5kg).

P041999

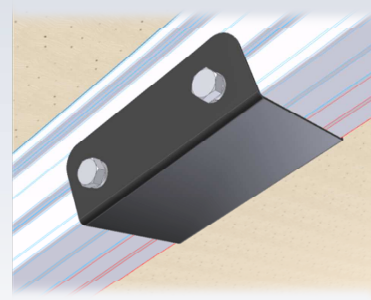
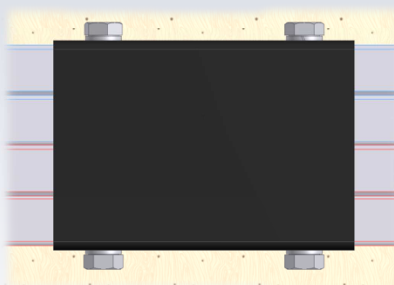

Leg Joiner Assembly.
Used for joining rostra assemblies together via their legs with a clamp & wing nut arrangement
(self weight: 1.5kg).

P042999

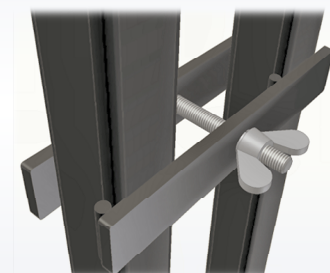
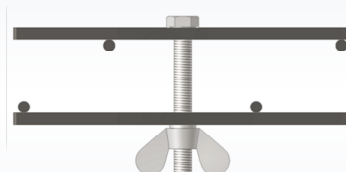

4Stage Steps with lifting hole and hook bracket easily connect the Steps to the 4Stage System.
18mm Euro B/ Class 0 Plywood, finished varnished or matt black..
Customised to suit your requirements or select from our standard range:

Size:

930mm Wide x 190mm Riser x 380mm High
9930mm Wide x 190mm Riser x 570mm High
9930mm Wide x 190mm Riser x 760mm High
9930mm Wide x 190mm Riser x 950mm High

Part Number:

P041800-W0930-R190-H380
P041800-W0930-R190-H570
P041800-W0930-R190-H760
P041800-W0930-R190-H950

Steps after 600mm high come complete with side handrails.

Also refer to the full 4Stage System Leaflets for details of:

4Stage Top - Standard Rostra Tops

4Stage Legs - Adjustable Range

4Stage Socket - Standard Socket for Handrail and Posts

4Stage Post - Post with Securing Cam Device for Handrails

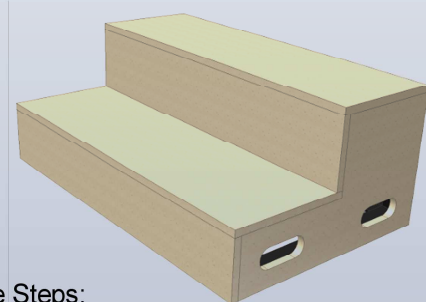

4Stage Steps:
P041800-W0930-R200-H400